

This grass area, managed without chemicals or improvement through addition of nitrogenous fertilisers

Management of grass promotes seed dispersal of cowslips by allowing full ripening of seed embryos prior to cutting.

Avoid planting in northern part of grass as prone to flooding and resident population of Ranunculus repens would prove too competitive for companion planting & diversity.

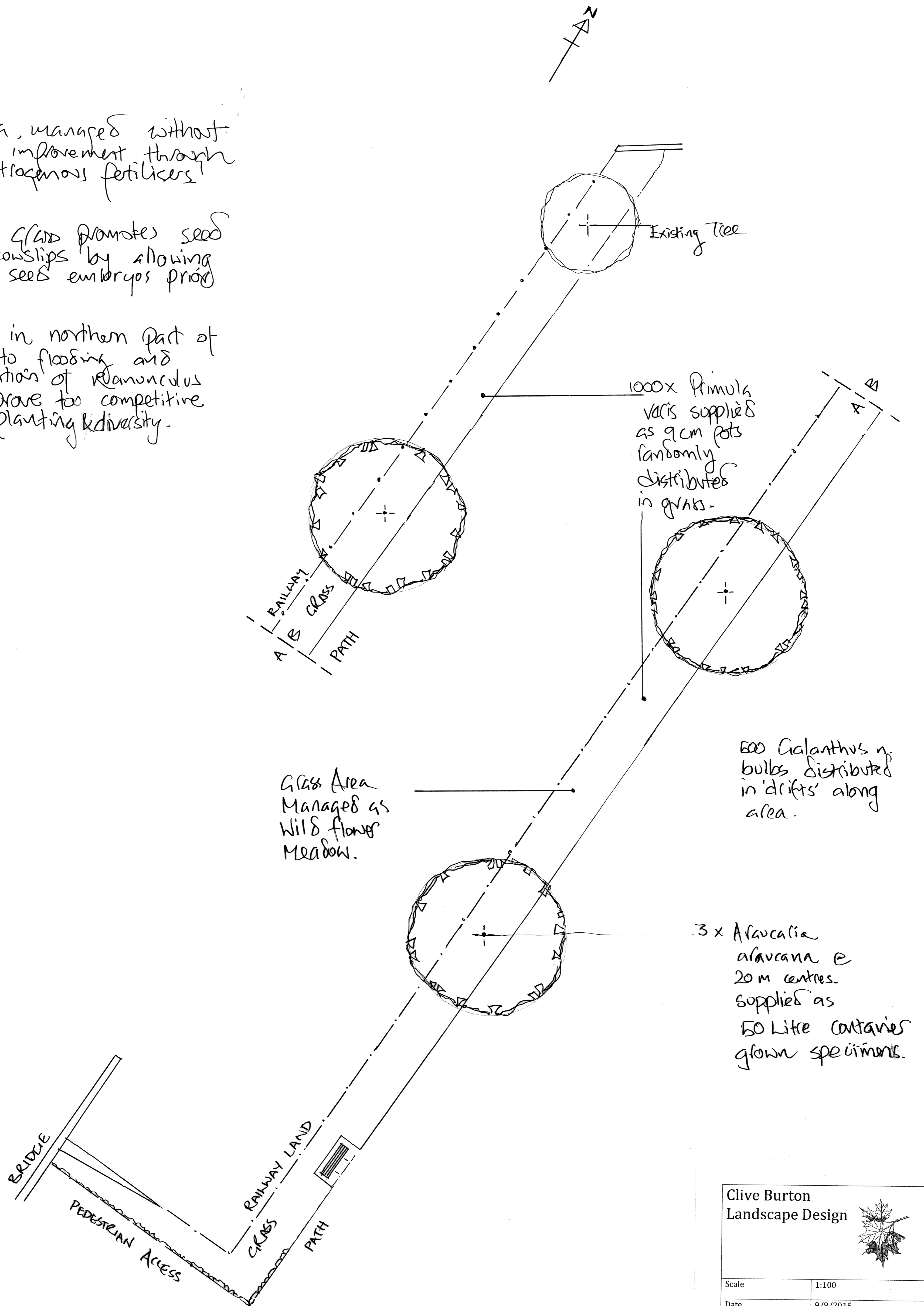

Project: Victoria Park: Client: Tor2/Kier Group: PLANTING PLAN SCHEDULE: Long Grass Strip East of Railway Line North from Railway Bridge to Bunnyland/Park Entrance.

Plant Type	Genus	Species	Variety/cv	Pot Size	Number
Trees	Araucaria	araucana		50L	X 3
					Total Trees X 3
Perennials for Naturalising	Primula	veris		9cm	X 1000
					Total Perennial Plants X 1000
Bulbs	Galanthus	nivalis			X 500
					Total Bulbs X 500

Clive Burton Landscape Design	
Scale	1:100
Date	9/8/2015
Scheme Title	Victoria Park Planting Redesign
Drawing Title	Long Grass Strip along East of Railway Line, from Railway Bridge to Bunnyland/Park Entrance. Planting Plan/Management Instruction.
Client	Tor2Ltd/ Kier
Signed	